

Dear Customer,  
CONGRATULATIONS. The RLPF100 Scrolling Digital License Plate Frame, when used as described, will give you years of dependable service in your car, truck, RV, or mini-van. We have taken numerous measures in quality control to ensure that your product arrives in top condition and will perform to your satisfaction. In the rare event that your RLPF100 Scrolling Digital License Plate Frame, contains a damaged or missing item, does not perform as specified, requires warranty service, or you have an installation problem, **DO NOT RETURN THIS PRODUCT TO THE STORE. PLEASE CALL OUR TOLL FREE NUMBER FROM THE U.S.A. AND CANADA 1-800-445-1797** and ask to speak with a member of our technical service team; or submit your questions by e-mail to customerservice@roadmasterusa.com and a member of our technical service team will respond by e-mail to your questions. Our in-house technical service team will expedite delivery of your part, advise you on installation, or help troubleshoot a problem with you. If your product needs warranty service, our technical service team representative will help you obtain the fastest remedy possible under the warranty.

## Parts



Scrolling Digital License Plate Frame



Remote Control



Mounting Nuts & Bolts

### SPECIFICATIONS

Power: 12VDC 400mA  
Operating Temperature: 0°C to 45°C Humidity: 95%

## Before You Start

Read these instructions carefully and completely before installing or using product. Remove clear plastic protector from the remote control's battery. **DO NOT LOSE** the remote control, it is the only way to input a message. **DO NOT TRY TO PROGRAM MESSAGES WHILE DRIVING.** The use of hand-held devices while driving is prohibited in many localities. Be sure to obey all Local, State, and Federal Traffic Laws regarding the use of this product.

GIVE US A CALL, WE'LL HELP YOU INSTALL.

PLEASE DO NOT RETURN PRODUCT TO STORE.  
Visit us on the WEB

[www.roadmasterusa.com](http://www.roadmasterusa.com)

For Information and Technical Assistance,  
Call Toll-Free in U.S.A. and Canada.

1-800-445-1797

## Installation

1. Remove your license plate and frame.
2. Re-install your license plate with the RLPF100 using the supplied nuts and bolts.
3. Connect the wires, maintaining polarity by connecting the Striped wire to 12V positive and the Solid wire to 12V negative ground.

NOTE: You may wire the RLPF100 into the trunk light circuit ahead of the trunk lid switch.

Note: For vehicle specific wiring diagrams contact the vehicle's manufacturer.

## Operation

### Remote Control

- INSERT - Inserts a character
- EDIT - Use to enter EDIT mode
- ENTER - Confirms an entry
- PREV - Moves to the previous character
- LEFT - Moves the cursor to the left
- RIGHT - Moves the cursor to the right
- NEXT - Moves to the next character
- SHIFT - Toggles between uppercase, lowercase, symbols, and numbers
- CLR - Deletes a single letter or clears a message from a memory location
- SLEEP - Toggles ON/OFF mode



NOTE: Battery has clear plastic protector installed at the factory that must be removed before using the remote

### Changing The Battery

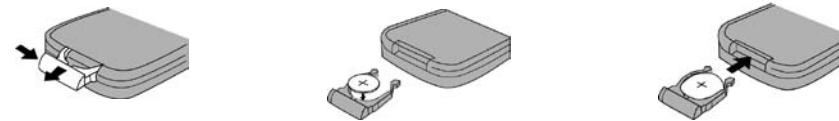

### Turning the RLPF100 On And Off

1. Start vehicle or turn ignition to accessory position to operate unit.
2. Press and hold the Sleep Button to turn the On or Off.

### CREATING A MESSAGE

**DO NOT TRY TO EDIT OR CREATE A MESSAGE WHILE OPERATING THE VEHICLE!**

#### Memory Location

First you will need choose a memory location to store your message. There are 5 memory locations. P :: 1, P :: 2, P :: 3, P :: 4, and P :: 5

1. Press the Edit Button once to enter the Edit mode. The screen will display "P :: 1". To use another memory location, press the Previous or Next Button.
2. Press the Enter Button to confirm the location.

NOTE: If the selected memory location contains a message, the message will be overwritten. If you don't want to overwrite the previously saved message you will need to scroll to an empty location.



Display of Memory Location

## Operation

### Message Speed

After you have selected a memory location, "SP:1" will be displayed. ("SP" indicates the speed at which your message will scroll, in this case 1)

- SP1 = Fast
- SP2 = Moderate
- SP3 = Slow

To change the speed;

1. Press either the Previous or Next Button to choose the desired scrolling speed.
2. Press the Enter Button to confirm the speed.

### Entering Your Messages

After you have selected a scrolling speed, a "█" will be displayed.

The blinking rectangle indicates an insertion point to input characters from 4 different character sets. The blinking rectangle also represents a blank space.

### List Of Characters

ABCDEFGHIJKLMNOPQRSTUVWXYZ

abcdefghijklmnopqrstuvwxyz

0123456789

! @ # \$ % & \* ( ) + " ' ? , / = < > ^ . ; : \ { } ~ [ ] € █

1. Press the Shift Button to toggle between the 4 different character sets.

2. Use the Previous and Next Buttons to scroll through the character sets. You can press the Shift Button at any time to toggle through the character sets.



Cursor

3. Press the Right Button to advance the insertion point to the next character or letter. Press the Left Button at any time to return to the previous character for editing.

4. Press the Enter Button to save the message. The entered message will be displayed and then begin scrolling at the selected speed.

### Displaying a Saved Message

1. Press the Previous or Next Buttons to go to the message you want displayed.
2. Press the Enter button

### Erasing or Editing a Saved Message

1. Display the saved message you want to delete.
2. Press the Edit Button to enter the Edit Mode.
3. Use the Right or Left Buttons to scroll through the message to highlight the character you wish to edit.
4. Press the Clear/Sleep Button to delete the highlighted character.

### To Erase the Entire Message

Press the Edit Button once and the memory location will be displayed. Press the Clear/Sleep Button to delete the message stored at this location.

### Changing the Displayed Message

While the RLPF100 is running a message, press the Previous or Next button to change the displayed message to another saved message.